

**ÁREA VERDE 01 - QUADRA 001 - Área=3.657,54 m²**

Vertice	Pera	Azimute	Distância	Coord. Norte	Coord. Este	Fator de Escala	Latitude	Longitude
18	118°13'58"	38,32	7003288,12	433308,299	0,99965133	27°05'28,85347" S	51°39'08,91877" W	
19	15	204°36'29"	49,10	7003219,997	435342,064	0,99965133	27°05'30,44839" S	51°39'07,86922" W
14	118°13'49"	42,98	7003175,359	435321,620	0,99965133	27°05'31,89569" S	51°39'08,71988" W	
15	118°13'49"	42,98	7003175,359	435321,620	0,99965133	27°05'31,89569" S	51°39'08,71988" W	
13	118°13'49"	42,98	7003175,359	435321,620	0,99965133	27°05'31,89569" S	51°39'08,71988" W	
12	118°13'49"	42,98	7003175,359	435321,620	0,99965133	27°05'31,89569" S	51°39'08,71988" W	
11	208°13'50"	61,20	7003109,619	435444,070	0,99965117	27°05'34,02288" S	51°39'04,28584" W	
2	208°13'50"	61,20	7003109,619	435444,070	0,99965117	27°05'34,02288" S	51°39'04,28584" W	
1	208°13'50"	208,39	7003070,049	435492,405	0,99965109	27°05'35,34706" S	51°39'02,53823" W	
17	18	348°12'07"	25,95	7003212,749	435333,690	0,99965138	27°05'30,67999" S	51°39'09,00126" W

**ÁREA VERDE 02 - QUADRA 002 - Área = 2.929,19 m²**

Vertice	Pera	Azimute	Distância	Coord. Norte	Coord. Este	Fator de Escala	Latitude	Longitude
10	118°13'49"	61,30	7003073,968	435504,418	0,99965102	27°05'33,22173" S	51°39'01,88359" W	
9	118°13'49"	48,00	7003046,002	435684,427	0,99965098	27°05'35,92765" S	51°39'01,92765" W	
8	118°13'49"	48,00	7003022,299	435968,715	0,99965091	27°05'38,91844" S	51°39'02,39633" W	
7	118°13'49"	48,00	7003002,299	436253,003	0,99965084	27°05'41,90922" S	51°39'02,86501" W	
6	37°13'59"	48,00	7003026,299	435971,919	0,99965076	27°05'34,66041" S	51°39'04,02496" W	
5	118°13'59"	12,15	7003026,299	435701,919	0,99965076	27°05'38,78897" S	51°39'04,93947" W	
4	208°13'59"	81,74	7003021,031	435712,622	0,99965070	27°05'38,87711" S	51°39'05,55083" W	
3	208°13'59"	103,58	7003021,031	435752,279	0,99965061	27°05'38,58898" S	51°39'05,91625" W	

**ÁREA VERDE 03 - QUADRA 003 - Área = 1.231,70 m²**

Vertice	Pera	Azimute	Distância	Coord. Norte	Coord. Este	Fator de Escala	Latitude	Longitude
62	118°13'49"	39,40	7003063,422	435722,650	0,99965073	27°05'34,93867" S	51°39'54,17171" W	
63	29	217°13'09"	46,59	7003063,422	435748,378	0,99965069	27°05'35,41054" S	51°39'54,20707" W
29	30	298°14'19"	23,12	7003032,319	435721,196	0,99965073	27°05'36,61171" S	51°39'54,23727" W
30	62	298°13'51"	46,02	7003033,260	435700,823	0,99965076	27°05'36,25288" S	51°39'54,97511" W

**ÁREA VERDE 04 - QUADRA 005 - Área = 667,22 m²**

Vertice	Pera	Azimute	Distância	Coord. Norte	Coord. Este	Fator de Escala	Latitude	Longitude
40	41	298°13'59"	15,71	7003248,626	435318,341	0,99965137	27°05'29,51934" S	51°39'08,82525" W
41	42	348°12'06"	23,51	7003248,626	435304,499	0,99965139	27°05'29,27007" S	51°39'09,32648" W
42	43	0°49'01"	28,37	7003270,056	435299,030	0,99965140	27°05'28,52180" S	51°39'09,49905" W
43	44	17°04'17"	2,91	7003307,307	435299,030	0,99965140	27°05'27,59894" S	51°39'09,47906" W
44	45	118°13'48"	12,80	7003310,206	435300,884	0,99965140	27°05'27,50963" S	51°39'09,44725" W
45	46	180°49'07"	24,02	7003304,246	435311,986	0,99965138	27°05'27,70520" S	51°39'09,04554" W
46	46	189°02'07"	32,30	7003280,229	435311,644	0,99965138	27°05'28,48571" S	51°39'09,06248" W

**ÁREA VERDE 05 - QUADRA 006 - Área=6.779,60 m²**

Vertice	Pera	Azimute	Distância	Coord. Norte	Coord. Este	Fator de Escala	Latitude	Longitude
73	74	298°13'46"	12,23	700316,059	435315,849	0,99965137	27°05'27,23693" S	51°39'08,90288" W
74	115	112°02'27"	80,62	7003323,844	435053,073	0,99965139	27°05'27,06710" S	51°39'09,28287" W
115	114	112°02'27"	53,75	7003400,910	435028,741	0,99965135	27°05'24,56642" S	51°39'09,41884" W
114	113	129°12'22"	31,04	7003390,727	435378,653	0,99965128	27°05'25,23076" S	51°39'06,64009" W
113	112	115°18'59"	33,84	7003354,807	435403,326	0,99965122	27°05'26,07852" S	51°39'05,48515" W
112	111	157°49'36"	12,27	7003340,336	435403,326	0,99965118	27°05'28,83398" S	51°39'04,35979" W
111	110	142°50'00"	19,48	7003285,457	435422,669	0,99965113	27°05'28,24532" S	51°39'03,23201" W
110	109	124°08'36"	22,26	7003272,976	435463,985	0,99965111	27°05'28,75044" S	51°39'02,86587" W
109	108	116°22'27"	18,71	7003260,483	435502,405	0,99965108	27°05'29,15957" S	51°39'02,19354" W
108	107	109°45'52"	51,13	7003252,171	435518,169	0,99965105	27°05'29,43253" S	51°39'01,53217" W
107	106	105°07'55"	8,13	7003234,862	435567,287	0,99965098	27°05'30,11529" S	51°39'59,36917" W
106	85	208°11'50"	61,77	7003231,473	435575,726	0,99965096	27°05'30,34737" S	51°39'59,50187" W
85	86	208°11'50"	61,77	7003231,473	435575,726	0,99965096	27°05'30,34737" S	51°39'59,50187" W
86	82	300°48'38"	48,05	7003246,632	435577,831	0,99965105	27°05'29,67229" S	51°39'01,69906" W
82	81	307°46'38"	48,05	7003271,270	435476,853	0,99965112	27°05'28,80633" S	51°39'03,63372" W
81	80	298°13'47"	115,57	7003307,446	435441,322	0,99965118	27°05'27,62288" S	51°39'04,34654" W
80	75	208°13'47"	115,57	7003307,446	435441,322	0,99965118	27°05'27,62288" S	51°39'04,34654" W
75	73	208°13'43"	50,00	7003362,112	435339,659	0,99965134	27°05'25,82318" S	51°39'08,03560" W

**ÁREA VERDE 06 - QUADRA 007 - Área = 4.734,75 m²**

Vertice	Pera	Azimute	Distância	Coord. Norte	Coord. Este	Fator de Escala	Latitude	Longitude
89	104	28°13'59"	6,50	7003221,767	435589,729	0,99965094	27°05'30,43252" S	51°39'58,97488" W
104	103	106°07'35"	64,34	7003227,494	435922,627	0,99965094	27°05'30,24891" S	51°39'58,86218" W
103	102	116°30'42"	40,85	7003205,692	435664,855	0,99965082	27°05'30,69786" S	51°39'58,26077" W
102	101	116°30'42"	40,85	7003205,692	435664,855	0,99965082	27°05'30,69786" S	51°39'58,26077" W
101	100	99°24'35"	73,80	7003187,456	435701,412	0,99965076	27°05'31,56836" S	51°39'54,26873" W
100	99	155°35'29"	17,31	7003175,423	435714,017	0,99965065	27°05'31,96907" S	51°39'52,29253" W
99	93	189°13'31"	62,34	7003159,657	435711,172	0,99965064	27°05'32,48320" S	51°39'52,03589" W
93	64	217°13'09"	21,87	7003096,121	435711,172	0,99965064	27°05'34,48146" S	51°39'52,41013" W
64	65	298°13'49"	22,36	7003080,709	435757,852	0,99965067	27°05'35,04514" S	51°39'52,89362" W
65	92	28°13'49"	83,51	7003091,284	435738,255	0,99965067	27°05'34,69815" S	51°39'52,89362" W
92	91	293°49'07"	83,51	7003143,773	435708,438	0,99965066	27°05'32,99896" S	51°39'52,37379" W
91	80	293°49'07"	83,51	7003143,773	435708,438	0,99965066	27°05'32,99896" S	51°39'52,37379" W
80	79	293°49'07"	83,51	7003143,773	435708,438	0,99965066	27°05'32,99896" S	51°39'52,37379" W
79	80	293°49'07"	83,51	7003143,773	435708,438	0,99965066	27°05'32,99896" S	51°39'52,37379" W
80	89	293°49'07"	83,51	7003143,773	435708,438	0,99965066	27°05'32,99896" S	51°39'52,37379" W

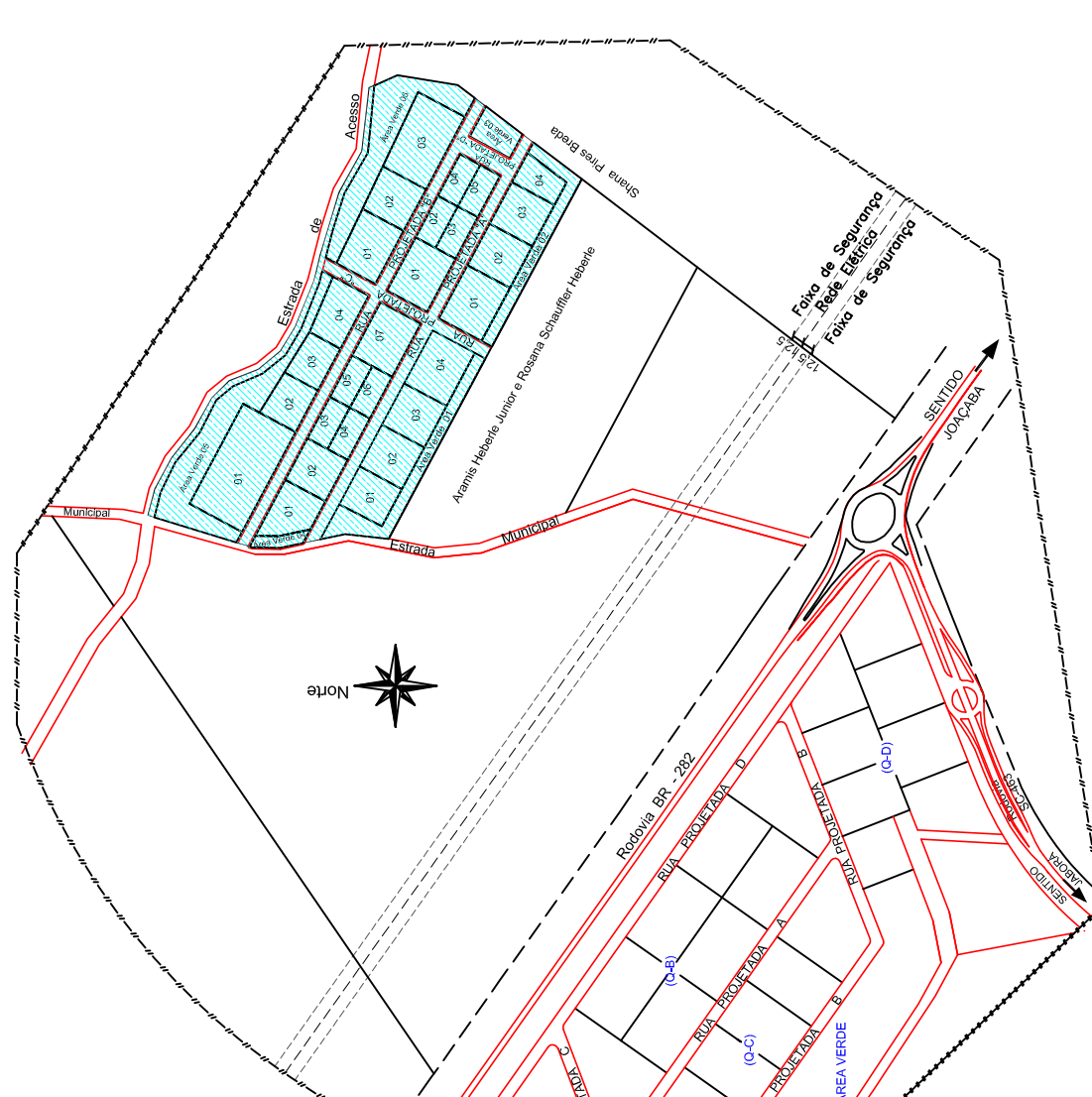

PLANTA DE LOCALIZAÇÃO DO PROJETO PROPOSTO  
ESCALA: RELATIVA

QUADRA 001			QUADRA 002		
LOTES	ÁREA	ÁREA	LOTES	ÁREA	ÁREA
LOTE 01	2.182,02 m²	LOTE 01	3.003,70 m²		
LOTE 02	2.352,00 m²	LOTE 02	2.352,00 m²		
LOTE 03	3.003,70 m²	LOTE 03	2.352,00 m²		
LOTE 04	3.003,70 m²	LOTE 04	1.463,97 m²		
ÁREA VERDE 01	3.657,54 m²	ÁREA VERDE 02	2.929,19 m²		
ÁREA TOTAL	13.547,26 m²	ÁREA TOTAL	12.100,86 m²		

QUADRA 003			QUADRA 004		
LOTES	ÁREA	ÁREA	LOTES	ÁREA	ÁREA
LOTE 01 - ÁREA VERDE 03	2.182,02 m²		LOTE 01	2.819,80 m²	
			LOTE 02	2.316,12 m²	
			LOTE 03	2.288,00 m²	
			LOTE 04	1.104,00 m²	
			LOTE 05	1.104,00 m²	
			LOTE 06	1.104,00 m²	
			LOTE 07	1.104,00 m²	
			LOTE 08 - ÁREA VERDE 04	667,22 m²	
			ÁREA TOTAL	12.427,14 m²	

QUADRA 005			QUADRA 006		
LOTES	ÁREA	ÁREA	LOTES	ÁREA	ÁREA
LOTE 01	5.779,42 m²	LOTE 01	2.896,00 m²		
LOTE 02	1.714,43 m²	LOTE 02	2.896,00 m²		
LOTE 03	2.225,36 m²	LOTE 03	2.896,00 m²		
LOTE 04 - ÁREA VERDE 05	6.779,60 m²	LOTE 04 - ÁREA VERDE 06	4.734,75 m²		
ÁREA TOTAL	18.109,82 m²	ÁREA TOTAL	14.176,02 m²		

QUADRA 007		
LOTES	ÁREA	ÁREA
LOTE 01	5.779,42 m²	2.896,00 m²
LOTE 02	1.714,43 m²	2.896,00 m²
LOTE 03	2.225,36 m²	2.896,00 m²
LOTE 04 - ÁREA VERDE 05	6.779,60 m²	14.176,02 m²
ÁREA TOTAL	18.109,82 m²	

**ARRUAMENTO E ESTRADA**

RUA	ÁREA
RUA PROJETADA "A"	6.523,83 m²
RUA PROJETADA "B"	7.159,85 m²
RUA PROJETADA "C"	2.194,47 m²
RUA PROJETADA "D"	1.150,36 m²
ESTRADA DE ACESSO	3.543,08 m²
ÁREA TOTAL	20.571,59 m²

**- ESTATÍSTICAS FINAIS -**  
Resumos das áreas

ÁREA MATRÍCULA Nº 4.068 (100,00%)	100.000,00 m²
ÁREA LOTES (66,12%)	56.116,40 m²
ÁREA ARRUAMENTOS (20,57%)	20.571,60 m²
ÁREA VERDE (20,00%)	20.000,00 m²
ÁREA INSTITUCIONAL (3,31%)	3.312,00 m²

NÚMERO DE LOTES ----- 33 un.  
NÚMERO DE QUADRAS ----- 07 un.

**MUNICÍPIO DE CATANDUVAS - SC**

PROJETO LOTEAMENTO DISTRITO INDUSTRIAL II  
LOCALIZAÇÃO DO PROJETO  
PLANTA URBANÍSTICA

ESTRADA MUNICIPAL  
PROXIMIDADES DA RODOVIA BR- 282

GISA APARECIDA GIACOMIN

Assinatura do Responsável Técnico

Assinatura da Prefeitura

MICHEL ALBERTI - ENG° CIVIL - CREA/SC 80.032-6

URB. 01/01

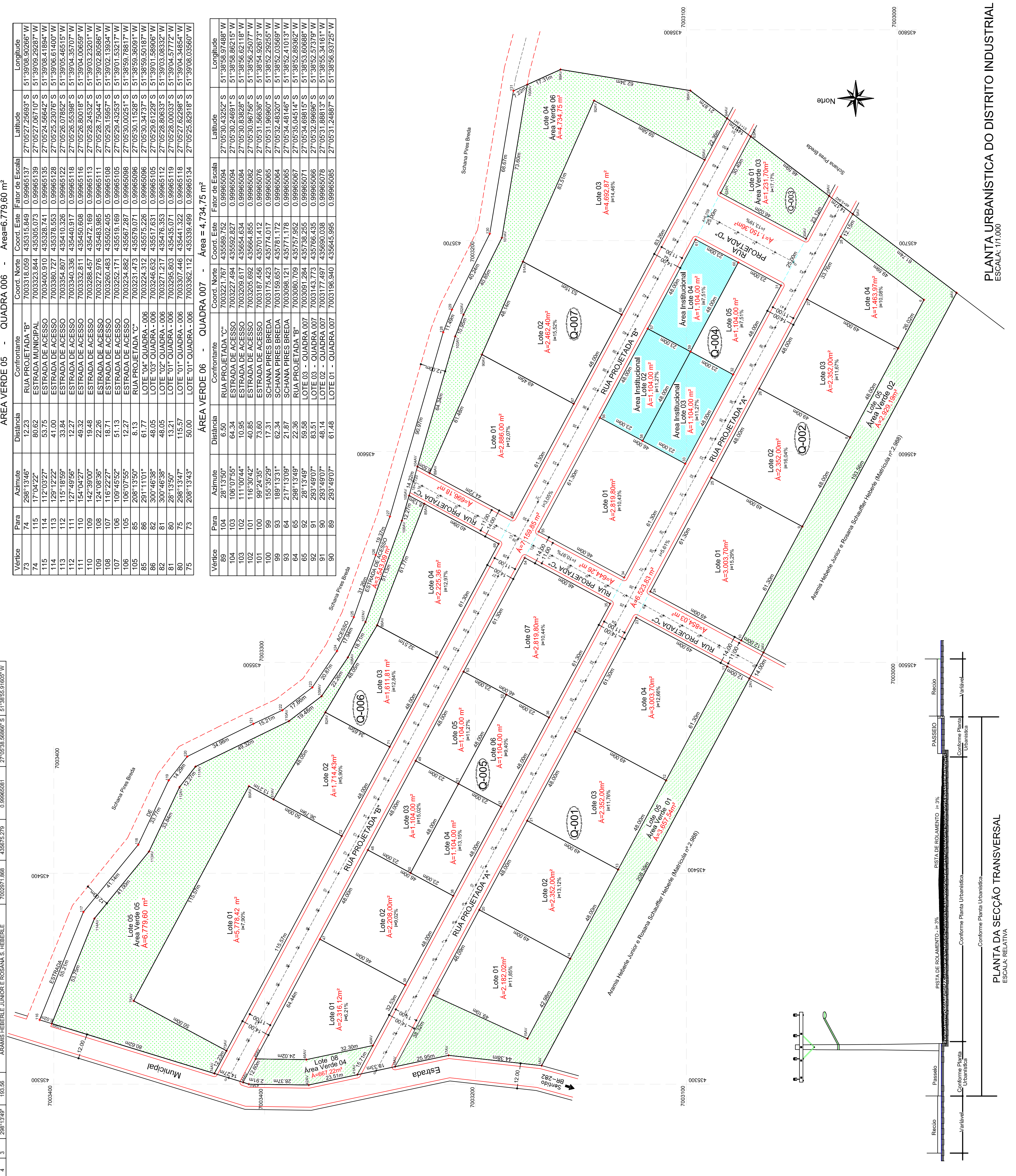

PLANTA URBANÍSTICA DO DISTRITO INDUSTRIAL II  
ESCALA: 1:1000

PLANTA DA SEÇÃO TRANSVERSAL  
ESCALA: RELATIVA