

ÁREA VERDE 01 - QUADRA 001 - Área=3.657,54 m²

Vértice	Para	Azimute	Distância	Confrontante	Coord. Norte	Coord. Este	Fator de Escala	Latitude	Longitude
18	19	118°13'58"	38,32	RUA PROJETADA "A"	7003238,127	435308,299	0,99965139	27°05'29,85347" S	51°39'09,19187" W
19	15	204°36'29"	49,10	LOTE 01 - QUADRA 001	7003219,997	435342,064	0,99965133	27°05'30,44839" S	51°39'07,96922" W
15	14	118°13'49"	42,98	LOTE 01 - QUADRA 001	7003175,359	435321,620	0,99965137	27°05'31,89569" S	51°39'08,71988" W
14	13	118°13'49"	48,00	LOTE 02 - QUADRA 001	7003155,029	435359,490	0,99965131	27°05'32,56284" S	51°39'07,34988" W
13	12	118°13'49"	48,00	LOTE 03 - QUADRA 001	7003132,323	435401,781	0,99965124	27°05'33,30788" S	51°39'05,81728" W
12	11	118°13'49"	61,30	LOTE 04 - QUADRA 001	7003109,619	435444,070	0,99965117	27°05'34,05288" S	51°39'04,28594" W
11	2	208°13'50"	12,00	RUA PROJETADA "C"	7003080,622	435498,081	0,99965109	27°05'35,00438" S	51°39'02,33013" W
2	1	298°13'49"	208,39	ARAMIS HEBERLE JUNIOR e ROSANA S. HEBERLE	7003070,049	435492,405	0,99965109	27°05'35,34705" S	51°39'02,53823" W
1	17	8°18'36"	44,38	ESTRADA MUNICIPAL	7003168,621	435308,802	0,99965139	27°05'32,11252" S	51°39'09,18670" W
17	18	348°02'07"	25,95	ESTRADA MUNICIPAL	7003212,736	435313,680	0,99965138	27°05'30,67959" S	51°39'09,00126" W

Área=3.657,54 m²

ÁREA VERDE 02 - QUADRA 002 - Área = 2.929,19 m²

Vértice	Para	Azimute	Distância	Confrontante	Coord. Norte	Coord. Este	Fator de Escala	Latitude	Longitude
3	10	28°13'50"	12,00	RUA PROJETADA "C"	7003063,426	435504,742	0,99965108	27°05'35,56440" S	51°39'02,09149" W
10	9	118°13'49"	61,30	LOTE 01 - QUADRA 002	7003073,998	435510,418	0,99965107	27°05'35,22173" S	51°39'01,88339" W
9	8	118°13'49"	48,00	LOTE 02 - QUADRA 002	7003045,002	435554,427	0,99965098	27°05'36,17318" S	51°38'59,92765" W
8	7	118°13'49"	48,00	LOTE 03 - QUADRA 002	7003022,299	435606,715	0,99965091	27°05'36,91814" S	51°38'58,39633" W
7	6	118°13'49"	26,02	LOTE 04 - QUADRA 002	7002999,589	435649,003	0,99965085	27°05'37,66312" S	51°38'56,86500" W
6	28	37°13'09"	49,59	ESTRADA MUNICIPAL	7002987,289	435671,924	0,99965081	27°05'38,06691" S	51°38'56,04999" W
28	5	118°13'59"	12,15	RUA PROJETADA "A"	7003026,779	435701,919	0,99965076	27°05'36,78805" S	51°38'54,38840" W
5	4	217°13'09"	61,74	SCHANA PIRES BREDA	7003021,031	435712,822	0,99965075	27°05'36,97111" S	51°38'54,55083" W
4	3	298°13'49"	193,56	ARAMIS HEBERLE JUNIOR e ROSANA S. HEBERLE	7002971,868	435675,279	0,99965081	27°05'38,56867" S	51°38'55,91605" W

ÁREA VERDE 03 - QUADRA 003 - Área = 1.231,70 m²

Vértice	Para	Azimute	Distância	Confrontante	Coord. Norte	Coord. Este	Fator de Escala	Latitude	Longitude
62	63	118°13'49"	30,40	RUA PROJETADA "B"	7003063,803	435722,590	0,99965073	27°05'34,93867" S	51°38'54,17711" W
63	29	217°13'09"	46,59	SCHANA PIRES BREDA	7003069,422	435749,378	0,99965069	27°05'35,41054" S	51°38'53,20707" W
29	30	298°14'19"	23,12	RUA PROJETADA "A"	7003032,319	435721,196	0,99965073	27°05'36,61171" S	51°38'54,23737" W
30	82	28°13'51"	46,02	RUA PROJETADA "D"	7003043,260	435700,823	0,99965076	27°05'36,25268" S	51°38'54,97511" W

Área=1.231,70 m²

ÁREA VERDE 04 - QUADRA 005 - Área = 667,22 m²

Vértice	Para	Azimute	Distância	Confrontante	Coord. Norte	Coord. Este	Fator de Escala	Latitude	Longitude
40	41	298°13'59"	15,71	RUA PROJETADA "A"	7003246,626	435318,341	0,99965137	27°05'29,51394" S	51°39'05,46515" W
41	42	348°02'06"	23,51	ESTRADA MUNICIPAL	7003256,058	435304,499	0,99965139	27°05'29,27007" S	51°39'09,32684" W
42	43	0°49'01"	28,37	ESTRADA MUNICIPAL	7003279,056	435299,626	0,99965140	27°05'28,52180" S	51°39'09,49909" W
43	44	17°04'17"	2,91	ESTRADA MUNICIPAL	7003307,426	435300,030	0,99965140	27°05'27,59984" S	51°39'09,47908" W
44	45	118°13'48"	12,60	RUA PROJETADA "B"	7003310,206	435300,884	0,99965140	27°05'27,50963" S	51°39'09,44755" W
45	46	180°49'00"	24,02	LOTE "01" QUADRA 005	7003304,246	435311,986	0,99965138	27°05'27,70520" S	51°39'09,04554" W
46	40	168°02'07"	32,30	LOTE "01" QUADRA 005	7003280,229	435311,644	0,99965138	27°05'28,48571" S	51°39'09,06248" W

ÁREA VERDE 05 - QUADRA 006 - Área=6.779,60 m²

Vértice	Para	Azimute	Distância	Confrontante	Coord. Norte	Coord. Este	Fator de Escala	Latitude	Longitude
73	74	298°13'46"	12,23	RUA PROJETADA "B"	7003318,059	435315,849	0,99965137	27°05'27,25693" S	51°39'08,90266" W
74	115	17°04'22"	80,62	ESTRADA MUNICIPAL	7003323,844	435305,073	0,99965139	27°05'27,06710" S	51°39'08,29287" W
115	114	112°03'27"	53,75	ESTRADA DE ACESSO	7003400,910	435328,741	0,99965135	27°05'24,56642" S	51°39'08,41894" W
114	113	129°12'22"	41,00	ESTRADA DE ACESSO	7003380,727	435378,553	0,99965128	27°05'25,23076" S	51°39'06,61400" W
113	112	115°18'59"	33,84	ESTRADA DE ACESSO	7003354,807	435410,326	0,99965122	27°05'26,07852" S	51°39'05,46515" W
112	111	127°49'56"	12,27	ESTRADA DE ACESSO	7003340,336	435440,917	0,99965118	27°05'26,55398" S	51°39'04,35707" W
111	110	154°04'27"	49,32	ESTRADA DE ACESSO	7003332,811	435450,608	0,99965116	27°05'26,80018" S	51°39'04,00659" W
110	109	142°39'00"	19,48	ESTRADA DE ACESSO	7003298,457	435472,169	0,99965113	27°05'28,24532" S	51°39'03,22011" W
109	108	124°08'36"	22,26	ESTRADA DE ACESSO	7003272,976	435463,985	0,99965111	27°05'28,75044" S	51°39'02,80568" W
108	107	116°22'27"	18,71	ESTRADA DE ACESSO	7003260,483	435502,405	0,99965108	27°05'29,15957" S	51°39'02,13934" W
107	106	109°45'52"	51,13	ESTRADA DE ACESSO	7003252,171	435519,169	0,99965105	27°05'29,43253" S	51°39'01,53217" W
106	105	106°07'55"	12,27	ESTRADA DE ACESSO	7003234,882	435567,287	0,99965098	27°05'30,00251" S	51°38'59,78817" W
105	85	208°13'50"	8,13	RUA PROJETADA "C"	7003231,473	435579,071	0,99965096	27°05'30,11528" S	51°38'59,36091" W
85	86	291°11'01"	61,77	LOTE "04" QUADRA - 006	7003224,312	435575,226	0,99965096	27°05'30,34737" S	51°38'59,50187" W
86	82	300°46'38"	48,05	LOTE "03" QUADRA - 006	7003246,632	435517,631	0,99965105	27°05'29,61229" S	51°39'01,58906" W
82	81	300°46'38"	48,05	LOTE "02" QUADRA - 006	7003271,217	435476,353	0,99965112	27°05'28,80633" S	51°39'03,08332" W
81	80	28°13'50"	13,21	LOTE "01" QUADRA - 006	7003295,803	435435,071	0,99965119	27°05'28,00033" S	51°39'04,57772" W
80	75	298°13'47"	115,57	LOTE "01" QUADRA - 006	7003307,446	435441,322	0,99965118	27°05'27,62298" S	51°39'04,34854" W
75	73	208°13'43"	50,00	LOTE "01" QUADRA - 006	7003362,112	435339,499	0,99965134	27°05'25,82918" S	51°39'08,03560" W

ÁREA VERDE 06 - QUADRA 007 - Área = 4.734,75 m²

Vértice	Para	Azimute	Distância	Confrontante	Coord. Norte	Coord. Este	Fator de Escala	Latitude	Longitude
89	104	28°13'50"	6,50	RUA PROJETADA "C"	7003221,767	435589,752	0,99965094	27°05'30,43252" S	51°38'58,97488" W
104	103	106°07'55"	64,34	ESTRADA DE ACESSO	7003227,494	435592,827	0,99965094	27°05'30,24691" S	51°38'58,86215" W
103	102	111°00'44"	10,95	ESTRADA DE ACESSO	7003209,617	435654,634	0,99965094	27°05'30,63828" S	51°38'56,62118" W
102	101	116°30'42"	40,85	ESTRADA DE ACESSO	7003205,692	435664,855	0,99965092	27°05'30,96756" S	51°38'56,25077" W
101	100	99°24'35"	73,60	ESTRADA DE ACESSO	7003187,456	435701,412	0,99965076	27°05'31,56636" S	51°38'54,92673" W
100	99	155°35'29"	17,31	SCHANA PIRES BREDA	7003175,423	435774,017	0,99965065	27°05'31,96960" S	51°38'52,29255" W
99	93	189°13'31"	62,34	SCHANA PIRES BREDA	7003159,657	435781,172	0,99965064	27°05'32,48320" S	51°38'52,03569" W
93	64	217°13'09"	21,87	SCHANA PIRES BREDA	7003098,121	435771,178	0,99965065	27°05'34,48146" S	51°38'52,41013" W
64	65	298°13'49"	22,36	RUA PROJETADA "B"	7003080,709	435757,952	0,99965067	27°05'35,04514" S	51°38'52,89362" W
65	92	28°13'49"	59,58	LOTE 03 - QUADRA 007	7003091,284	435738,255	0,99965071	27°05'34,69815" S	51°38'53,60688" W
92	91	293°49'07"	83,51	LOTE 03 - QUADRA 007	7003143,773	435766,435	0,99965066	27°05'32,99696" S	51°38'52,57379" W
91	90	293°49'07"	48,14	LOTE 02 - QUADRA 007	7003177,497	435690,038	0,99965078	27°05'31,88813" S	51°38'55,34161" W
90	89	293°49'07"	61,48	LOTE 01 - QUADRA 007	7003196,940	435645,995	0,99965085	27°05'31,24887" S	51°38'56,93725" W

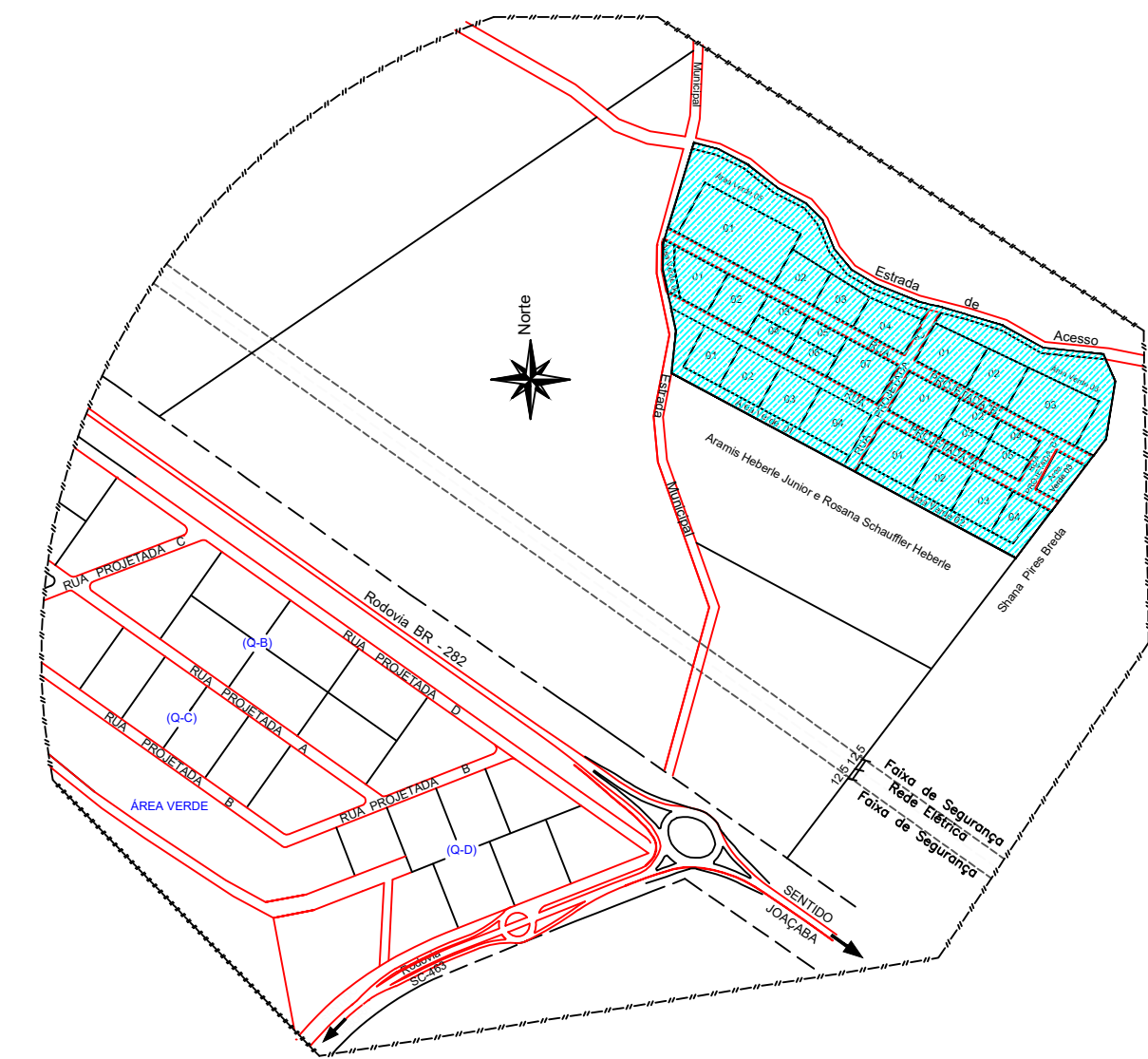

PLANTA DE LOCALIZAÇÃO DO PROJETO PROPOSTO  
ESCALA: RELATIVA

QUADRA 001		QUADRA 002	
LOTES	ÁREA	LOTES	ÁREA
LOTE 01	2.182,02 m²	LOTE 01	3.003,70 m²
LOTE 02	2.352,00 m²	LOTE 02	2.352,00 m²
LOTE 03	2.352,00 m²	LOTE 03	2.352,00 m²
LOTE 04	3.003,70 m²	LOTE 04	1.463,97 m²
LOTE 05 - ÁREA VERDE 01	3.657,54 m²	LOTE 05 - ÁREA VERDE 02	2.929,19 m²
ÁREA TOTAL	13.547,26 m²	ÁREA TOTAL	12.100,86 m²

QUADRA 003	
LOTES	ÁREA
LOTE 01 - ÁREA VERDE 03	2.182,02 m²

QUADRA 004		QUADRA 005	
LOTES	ÁREA	LOTES	ÁREA
LOTE 01	2.819,80 m²	LOTE 01	2.316,12 m²
LOTE 02 (INSTITUCIONAL)	1.104,00 m²	LOTE 02	2.208,00 m²
LOTE 03 (INSTITUCIONAL)	1.104,00 m²	LOTE 03	1.104,00 m²
LOTE 04 (INSTITUCIONAL)	1.104,00 m²	LOTE 04	1.104,00 m²
LOTE 05	1.104,00 m²	LOTE 05	1.104,00 m²
ÁREA TOTAL	7.235,80 m²	LOTE 06	1.104,00 m²
		LOTE 07	2.819,80 m²
		LOTE 08 - ÁREA VERDE 04	667,22 m²
		ÁREA TOTAL	12.427,14 m²

QUADRA 006		QUADRA 007	
LOTES	ÁREA	LOTES	ÁREA
LOTE 01	5.778,42 m²	LOTE 01	2.886,00 m²
LOTE 02	1.714,43 m²	LOTE 02	2.462,40 m²
LOTE 03	1.611,81 m²	LOTE 03	4.692,87 m²
LOTE 04	2.225,36 m²	LOTE 04 - ÁREA VERDE 06	4.734,75 m²
LOTE 05 - ÁREA VERDE 05	6.779,60 m²	ÁREA TOTAL	14.776,02 m²
ÁREA TOTAL	18.109,62 m²		

ARRUAMENTO E ESTRADA	
RUA	ÁREA
RUA PROJETADA "A"	6.523,83 m²
RUA PROJETADA "B"	7.159,85 m²
RUA PROJETADA "C"	2.194,47 m²
RUA PROJETADA "D"	1.150,36 m²
ESTRADA DE ACESSO	3.543,09 m²
ÁREA TOTAL	20.5